

## Tower components

- The axial fan is fitted at the top of the tower and is driven by a geared motor.
- The distribution pipes are made of polypropylene.
- Several ABS nozzles spray the water from the cooling circuit, evenly over the fill material. The obstruction of the spray nozzles is almost impossible due to the dimensions of their steps.
- The fill packs are welded PP/PVC structured blocks, highly resistant to heat.
- The droplet separator is made of PP/PVC panels. It is highly efficient and prevents water loss due to the action of the fan.
- The tower casing is made of hot galvanised profiled steel, and the cladding is made of fibreglass-reinforced polyester with louvres to prevent water spray losses.
- The water-collecting basin can be supplied, upon request, in fibreglass-reinforced polyester.

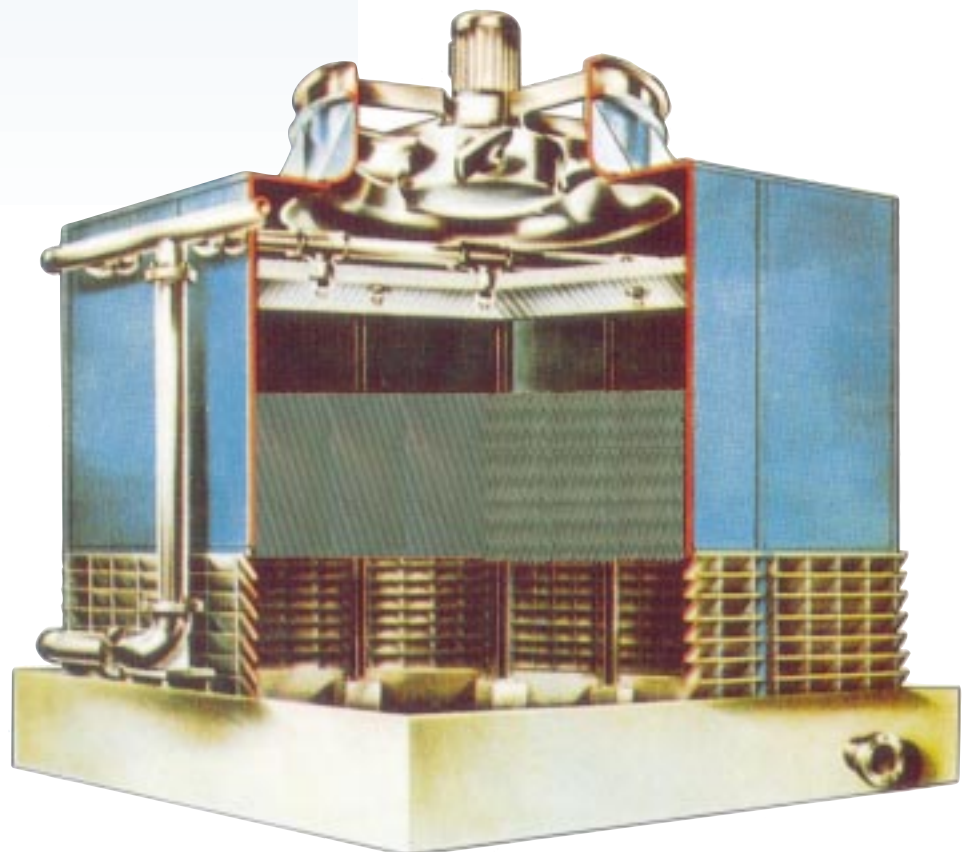

# COOLING TOWERS - EWB



- Modular design
- Corrosion free
- Industrial applications
- Easy maintenance
- Big capacity (500 - 10.000 m<sup>3</sup>/h)

[www.sulzercoolingtowers.com](http://www.sulzercoolingtowers.com)

**EWK** Former **SULZER**

Towers type EWB 1300 - EWB 2875

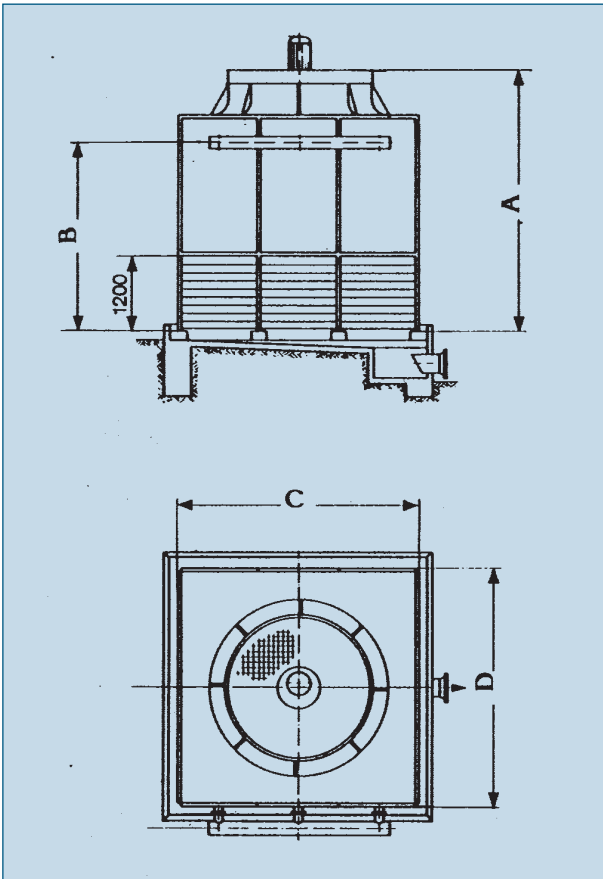

NOTE: EWK has a continuously advancing policy in the development of models. Therefore the specifications are subject to changes without prior notice.

Tower type	Power in KW with wb. = 24°C		Weight		Motor power KW	Dimensions (mm)				
	35/30°C	40/30°C	in service Kg	empty Kg		A	B	C	D	E
EWB 1300/06	1977	2674	3725	2725	11	4122	2848	3700	3700	-
EWB 1300/09	2093	3256	3900	2900	15	4122	2848	3700	3700	-
EWB 1730/03	2529	3430	4435	3035	15	4052	2848	3700	4900	-
EWB 1730/06	2820	3779	4665	3265	18,5	4052	2848	3700	4900	-
EWB 1730/09	-	4032	4900	3500	18,5	4052	2848	3700	4900	-
EWB 2300/03	3372	4535	5980	4080	18,5	4268	2848	4900	4900	-
EWB 2300/06	3750	5116	6290	4390	22	4268	2848	4900	4900	-
EWB 2300/09	-	5698	6600	4700	22	4268	2848	4900	4900	-
EWB 2875/03	4244	-	8420	6020	22	4322	2848	4900	6100	-
EWB 2875/06	4680	6395	8810	6410	30	4322	2848	4900	6100	-
EWB 2875/09	-	7093	9200	6800	30	4322	2848	4900	6100	-

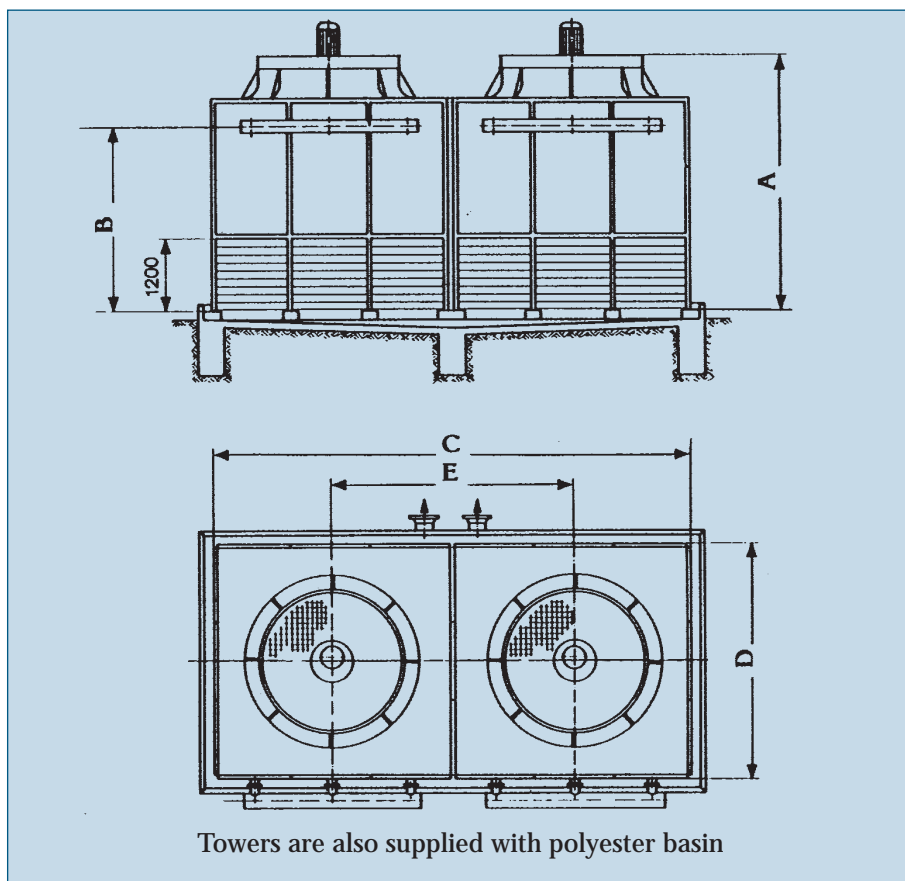

Tower type	Power in KW with wb. = 24°C		Weight in service empty		Motor power KW	Dimensions (mm)				
	35/30°C	40/30°C	Kg	Kg		A	B	C	D	E
EWB 3460/03	5087	6686	7675	5870	2 x 15	4052	2848	7350	4900	3650
EWB 3460/06	5669	7558	8140	6335	2 x 18,5	4052	2848	7350	4900	3650
EWB 3460/09	-	8605	8605	6800	2 x 18,5	4052	2848	7350	4900	3650
EWB 4600/03	6686	9186	11050	7550	2 x 18,5	4268	2848	9750	4900	4850
EWB 4600/06	7500	10174	11675	8175	2 x 22	4268	2848	9750	4900	4850
EWB 4600/09	-	11453	12300	8800	2 x 22	4268	2848	9750	4900	4850
EWB 5750/03	8372	-	14950	9950	2 x 22	4322	2848	9750	6100	4850
EWB 5750/06	9390	12741	15525	10725	2 x 30	4322	2848	9750	6100	4850
EWB 5750/09	-	14244	16300	11500	2 x 30	4322	2848	9750	6100	4850
EWB 7200/06	11628	15988	20230	15030	2 x 37	4266	2848	12250	6150	6100
EWB 7200/09	-	17733	21200	16000	2 x 37	4266	2848	12250	6150	6100